



# Illinois Chapter of the American Fisheries Society 62nd Annual Conference

**February 27-29, 2024**

Bloomington-Normal Marriott Hotel & Conference Center

Normal, IL

Nathan Grider – President

Ben Lubinski – President-Elect

Jason DeBoer – Secretary

Rich Lewis – Treasurer

Joe Parkos – Past-President

Rebekah Anderson and Seth Love - Members at Large

**THANK YOU TO OUR SPONSORS!**

**Gold Level - \$500**

Aquatic Control

**Silver Level - \$250**

American Farmland Trust

**Bronze Level - \$100**

Hank's Marine – Raymond, IL

## **American Fisheries Society Meeting Code of Conduct**

AFS is committed to providing a safe, productive, and welcoming environment for all meeting participants

### **Purpose:**

American Fisheries Society (AFS) meetings are among the most respected scientific meetings of fisheries professionals in the natural resource scientific community. AFS values the diversity of views, expertise, opinions, backgrounds, and experiences reflected among all attendees, and is committed to providing a safe, productive, and welcoming environment for all meeting participants and AFS staff. All participants, including, but not limited to, attendees, speakers, volunteers, exhibitors, staff, service providers, and others, are expected to abide by this Meetings Code of Conduct.

### **Expected Behaviors:**

- Treat all participants, attendees, AFS staff, and vendors with respect and consideration, valuing a diversity of views and opinions, and critiquing ideas rather than individuals.
- Refrain from demeaning, discriminatory, or harassing behavior and speech directed toward other attendees, participants, AFS staff, and suppliers/vendors.
- Be mindful of your surroundings and of your fellow participants. Alert AFS staff or venue event staff if you notice a dangerous situation or someone in distress.
- Respect the rules and policies of the meeting venue, hotels, AFS-contracted facility, or any other venue.
- To foster a welcoming environment, assist AFS members with impaired physical or cognitive abilities, if necessary.

### **Unacceptable Behaviors:**

- Harassment, intimidation, or discrimination in any form is unacceptable. Harassment includes speech or behavior that is not welcome or is personally offensive. Behavior that is acceptable to one person may not be acceptable to another, so use discretion to be sure respect is communicated. Harassment intended in a joking manner still constitutes unacceptable behavior. Regardless of your intent, if you are advised directly or by another party that some aspect of your speech or behavior at an AFS meeting is harassment, you are expected to stop engaging in such speech or behavior.
- Do not physically or verbally abuse any attendee, speaker, volunteer, exhibitor, AFS staff member, service provider, or other meeting guest.
- Examples of unacceptable behavior include, but are not limited to, unwelcome or offensive verbal comments related to age, appearance, or body size, employment or military status, ethnicity, gender identity and expression, individual lifestyle, marital status, national origin, physical or cognitive ability, political affiliation, sexual orientation, race, or religion. Harassment can also include the use of sexual and/or discriminatory images in public spaces or in presentations; deliberate intimidation; stalking; following; harassing photography or recording; sustained disruption of talks or other events; bullying behavior; inappropriate physical contact; and unwanted sexual attention.
- Appropriate and responsible personal use of photographs or posts to social media of another individual's oral presentation, poster, or likeness is acceptable unless permission is specifically denied by the individual.
- Do not disrupt talks at oral or poster session or activities in the exhibit hall or at other events organized by AFS at the meeting venue, hotels, or other AFS-contracted facilities.

- Any retaliation against participants for reporting unacceptable behavior is unacceptable. Like harassment or discrimination, retaliation against reporting poor behavior will be subject to consequences.

**Reporting Unacceptable Behavior:**

- Anyone experiencing or witnessing behavior that constitutes an immediate or serious threat to public safety at any time should contact local law enforcement (by calling 911) and immediately notifying facility security without delay.
- If you are not in immediate danger but feel that you are the subject of unacceptable behavior, you are encouraged to file a formal complaint to the AFS Ethics and Professional Conduct Committee and/or an AFS officer or the AFS Executive Director which will then be forwarded to the Ethics and Professional Conduct Committee for assessment.

**Consequences:**

- Anyone requested to stop unacceptable behavior is expected to comply immediately.
- Consequences to unacceptable behavior will be determined by the AFS Ethics and Professional Conduct Committee in conjunction with AFS officers and the AFS Executive Director.
- Consequences may include one or more of the following actions:
  - Dismissal from the meeting without refund
  - Reporting to your agency
  - Exclusion from any future AFS (sub unit/chapter/division) meetings for five years
  - Revoke of AFS membership without the opportunity for renewal for five years
  - If the offense is criminal, local law enforcement will be contacted.

## IL AFS Code of Conduct



# The Illinois Chapter of The American Fisheries Society

62nd Annual Meeting

February 27-29, 2024

Bloomington-Normal Marriott Hotel & Conference Center

Normal, IL

## Schedule:

### Tuesday February 27

8am-12pm Workshop: Basics of ArcGIS Pro

Location: *Beaufort Meeting Room*

11:00am – 5:00pm Registration Table – Check in

Location: *Hallway near Redbird AB Rooms*

1:00 – 1:10pm President’s Welcome Address – Nathan Grider (*Redbird C Room*)

1:10 – 2:50pm Session 1: Moderator – Jeremy Tiemann

Location: *Redbird C Room*

1:10 – 1:30	Milton Tan	A Tale of Two Shiners: Distribution and genomic diversity of Mimic and Channel Shiners in the Upper Mississippi River
1:30 - 1:50	Josh Bruegge	Competition and co-occurrence between two madtoms in the Vermilion River
1:50 – 2:10	Mark Davis	The Sculpin, the Shiner, and the Cavefish: Conservation genomics of peripheral populations of Illinois fishes
2:10 – 2:30	Jeremy Tiemann	Mitigation from incidental take authorizations and what it has meant for conservation in Illinois
2:30 – 2:50	Philip Willink	Native lampreys do what? How are we supposed to conserve that?

2:50 – 3:10 Break

Abstracts



3:10 – 4:50pm Session 2: Moderator – Dave Glover

Location: *Redbird C Room*

3:10 – 3:30	William Fick	Environmental influences on abundance of planktonic organisms within a river-to-reservoir transitional habitat
3:30 – 3:50	Ryan Skowronski	Impacts of habitat enhancement on the functional guilds of fishes in several Midwestern streams
3:50 – 4:10	Tyler Schartel	Developing species distribution models to update stream biological characterizations and assessments
4:10 – 4:30	Stephen Pescitelli	Dam removals combined with expansion of Tunnel and Reservoir Plan yields restoration milestones for Des Plaines River fishery
4:30 – 4:50	Trent Thomas	The Mackinaw River Basin: State of the Fisheries

5:00 – 7:00pm Dinner on your own

7:00 – 9:00pm Student/Mentor Social

Location: *Redbird B Room*

---

### **Wednesday February 28**

**Breakfast – On your own**

8:00am – 5:00pm Registration Table – Check-in

Location: *Hallway near Redbird AB Rooms*

8:30 – 9:40am: Poster Session #1

Location: *Hallway near Redbird AB Rooms*

Garrett Johnson	Simulating the effects of fish orientation on fish length estimates from side looking split beam echosounder surveys
Liam Ward	Bias in hydroacoustic data processing can lead to different fish population estimates
Patrick W. Padilla	Growth and maximum length comparisons of Silver Carp ( <i>Hypophthalmichthys molitrix</i> ) within three Ohio River Pools
Eric Brossman	Use of acoustic telemetry array to assess movement of Invasive Carp in the Illinois River

Abstracts



Benjamin Marcek	How much is enough? A resampling analysis to inform side-looking, split-beam echosounder surveys in large rivers
Manisha Pant	Reimplementation of the LTRM Macroinvertebrate Component in the Mississippi and Illinois rivers
Brandon Harris	Oriental Weatherfish ( <i>Misgurnus anguillicaudatus</i> ) distribution, frequency of occurrence, and relative abundance in pools of the Illinois Waterway, Illinois
Kathryn Conatser	Juvenile Black Carp habitat selection with impacts on bivalve predation
Amy Schneider	Acute exposure to water from the Chicago Area Waterway System (CAWS) alters gene expression in Silver Carp
Brian Metzke	Can fish feel the wind?
Amelia Finnell	Sanding or sectioning: which method provides more precise age estimates for invasive Silver Carp?

9:50 – 11:50am: Session #3 Moderator – Blake Ruebush

Location: *Redbird C Room*

9:50 – 10:10	Allison Hay	Seasonal implications of live release angling tournaments on Largemouth Bass
10:10 – 10:30	Justin Lombardo	Long term effects of angling on size structure and parental care of nesting Black bass
10:30 – 10:50	Jeremy Facer	Influence of supplemental habitat type and location on prey and fish aggregation
10:50 – 11:10	Charles Roswell	Harvest characteristics of a changing recreational Yellow Perch Fishery in Lake Michigan, Illinois
11:10 – 11:30	Jeff Kopaska	The Iowa Walleye Challenge - Using a statewide fishing tournament to assess Walleye populations
11:30 – 11:50	Michael Mounce	Regulation Cheat-Sheet: Rate function criteria for effective application of appropriate fishing regulation type

12:00 – 1:00pm: Lunch – Provided

Location: *Redbird AB Rooms*

1:00 – 2:40pm: Session #4 Moderator – Jim Garavaglia

Location: *Redbird C Room*

1:00 – 1:20	Dan Roth	Effectiveness of benthic electrified trawling to monitor juvenile Ictalurids in a large river
1:20 – 1:40	Carley Capon	Assessing the impacts of restored river connectivity on Catostomidae populations
1:40 – 2:00	Mitch Rosandich	A multigear approach assessing Channel Catfish population demographics in four Illinois impoundments
2:00 – 2:20	Valerie Thompson	Channel Catfish population status in the lower Wabash River following updated harvest regulations



2:20 – 2:40 Sara Tripp Trends in commercial harvest of catfish

2:40 – 2:50pm: Short Break

Invited Speaker:

Location: *Redbird C Room*

2:50 – 3:30 CPO Brandon Fehrenbacher Dedicated organisms in Trade Law Enforcement Units

3:30 – 4:40pm: Poster Session #2 – Snacks and Drinks provided

Location: *Hallway near Redbird AB Rooms*

Rebecca F Lucas	Evaluating the fish community structure in four pools of the Ohio River using electrified fishing techniques
Stefan Tucker	Secrets of The Rock River, IL. Investigations into Shovelnose Sturgeon population dynamics
Bret Dannis	Persistent morphological differences between crappie species
Joshua Temiloluwa Oyeboade	Comparative analysis of relative gape size and ecological adaptations in piscivorous fish: A case study in Illinois River ecosystems
Yong Cao	Comparing five machine learning algorithms for predicting species richness of multiple taxonomic groups and ranking environmental variables
Jackson Glomb	Impacts of angling tournament culling practices on Largemouth Bass ( <i>Micropterus nigricans</i> )
Tovah Brooks	Backwater connectivity impacts on selected riverine fishes on the lower Illinois River
Elizabeth Henry	Effects of sampling design on hydroacoustically-derived fish population characteristics in Ohio River Pools
Shasta Kamara	Physiological stress response of Paddlefish under different acclimation temperatures
Abigail Rick	Reconnecting urban lakes: Effects of physical and hydrological conditions on fish passage

4:45 – 6:45pm: Business Meeting

Location: *Redbird C Room*

7:00 – 10:00pm: Banquet Dinner Provided then Raffle

Location: *Redbird AB Rooms*





**Thursday February 29**

**Breakfast – On your own**

8:00am – 12:00pm Registration Table – Check-in  
Location: *Hallway near Redbird AB Rooms*

8:30 – 10:10am: Session #5 Moderator – Jason DeBoer  
Location: *Redbird C Room*

8:30 – 8:50	Michael Spear	Reduction of large vessel traffic improves water quality and alters fish habitat-use throughout a large river
8:50 – 9:10	Rafael Davila Jr.	Match-mismatch dynamics of zooplankton and larval fish in the Illinois River under changing hydrologic conditions
9:10 – 9:30	Sydney McAndrews	Stream restoration alters the food web structure and basal energy sources in urban and agricultural streams in the Midwestern United States
9:30 – 9:50	Tanya Fendler	Are rivers becoming more suitable for invasive carp?
9:50 – 10:10	Coy Blair	Determining drivers of Silver Carp habitat selection in the Wabash River System

10:10 – 10:30am: Break

10:30 – 12:10pm: Session #6 Moderator – Claire Snyder  
Location: *Redbird C Room*

10:30 – 10:50	Vaskar Nepal	Influence of protected areas on fish diversity in Nepal
10:50 – 11:10	North Joffe-Nelson	Social-Ecological trends in recruitment, retention, and reactivation (R3) among Illinois anglers
11:10 – 11:30	Mike Louison	Differential foraging response to multiple microplastic types by Bluegill <i>Lepomis macrochirus</i>
11:30 – 11:50	Abigail Roussin	A larger gape size does not lead to greater body condition in Bowfin
11:50 – 12:10	Dusty Swedberg	Digging Deep: Resurveying Illinois' Burrowing Crayfish and Species of Greatest Conservation Need

12:10 – 12:30pm: Closing Remarks and Award Announcements

Abstracts



## Some Local Eateries and Establishments

The Coffee Hound – Coffeehouse with locally roasted brews, espresso drinks and baked goods. Open 6:30AM – 4PM. 2-minute walk from Conference Center.

The Rock Café – Modern, brick-walled place for Mediterranean options & American eats, from gyros to burgers. Open 11AM – 8PM. 2-minute walk from the Conference Center.

Medici – Bi-level restaurant & bar serving seasonal American fare, pizzas & over 30 draft beers in a modern space. Open 11AM – 9PM. 2-minute walk from Conference Center.

Maggie Miley's – Dublin-inspired pub with cottage-meets-Victorian décor, classic fare, import beers & Irish whiskey. Open 11AM – 1AM. 5-minute walk from Conference Center.

Pizza Paya – Best Pizza in Bloomington – Normal. Gluten Free, Vegan, and Vegetarian Pizza options. Open 11AM – 9PM. 4-minute walk from Conference Center.

Fiala Brothers Brewery & Beer Hall – Brewpub with locally crafted beer and delicious, creative grilled cheese sandwiches. Vegan grilled cheese option. Open 11AM – 12AM. 5-minute walk from the Conference Center.

Pub II – Enduring hangout near campus offering many TVs, pub grub & a beer garden for sports fans. Open 11AM – 1AM. 7-minute walk from the Conference Center.

### **In Hotel Options:**

Jesse's Grill – Open 6:30AM – 2PM, then 5PM – 10PM. Bar open until 12AM

Caffeina's Café – Open for breakfast and lunch

**Notes:**

# Conference Center Layout

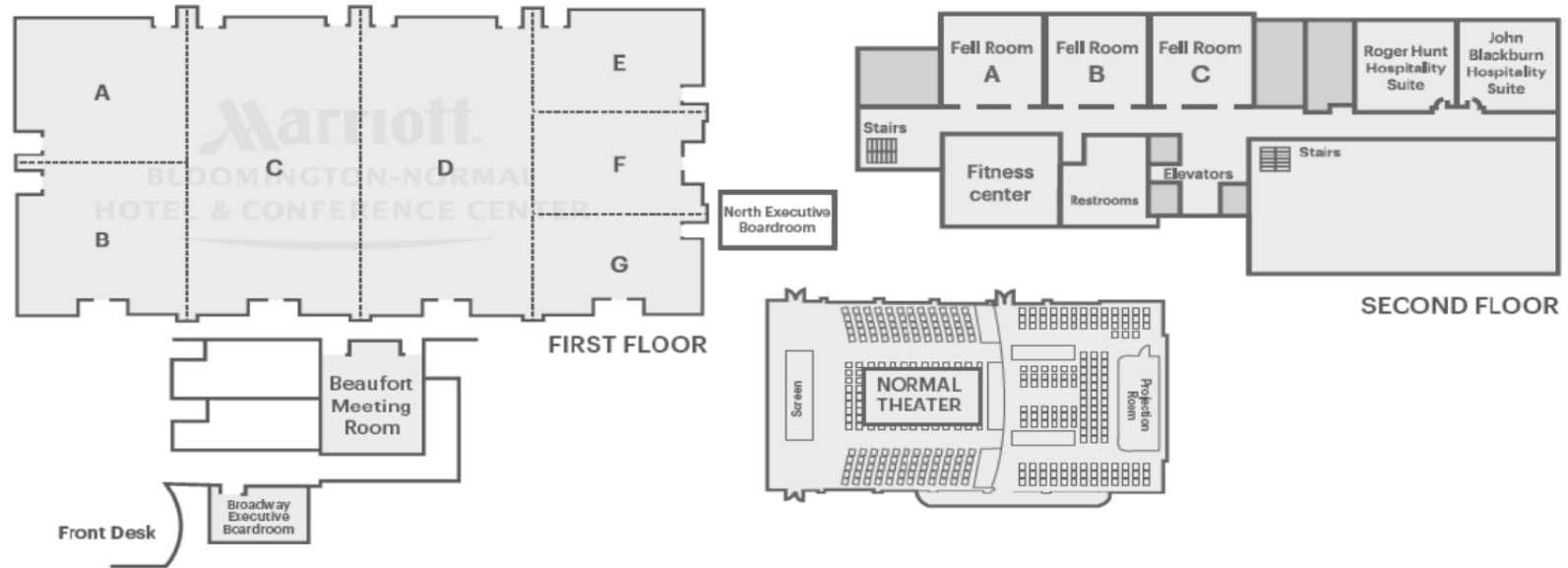

ROOM	DIMENSIONS		CAPACITIES						
	W x L x H	SQ. FT	BANQUET	CLASSROOM	THEATER	CRESCENT ROUNDS (6)	CONFERENCE	U-SHAPE	HOLLOW SQUARE
Redbird Ballroom (A-G)	200 x 100 x 35	20,000	1,200	-	2,000	720	-	-	-
Redbird A	50 x 50 x 35	2,500	130	70	150	78	34	30	36
Redbird Ballroom (A-G)	50 x 50 x 35	2,500	130	75	150	78	34	30	36
Redbird A & B	50 x 100 x 35	5,000	220	135	300	132	-	-	-
Redbird C	50 x 100 x 35	5,000	220	160	400	132	-	-	-
Redbird D	50 x 100 x 35	5,000	220	160	400	132	-	-	-
Redbird E	50 x 33 x 35	1,650	80	50	120	48	28	28	32
Redbird F	50 x 33 x 35	1,650	70	50	30	42	28	28	32
Redbird G	50 x 33 x 35	1,650	70	50	120	42	28	28	32
Redbird E, F & G	50 x 100 x 35	5,000	220	125	300	132	-	-	-
Beaufort	26 x 31.5 x 10	825	40	30	50	24	18	24	26
Fell A	28 x 30 x 8.6	720	40	30	50	24	18	24	26
Fell B	28 x 30 x 8.6	720	40	30	50	24	18	24	26
Fell C	28 x 30 x 8.6	720	40	30	50	24	18	24	26
North Street Boardroom	24 x 16 x 10	384	-	-	-	-	12	-	-
Broadway Ave Boardroom	24 x 16 x 10	390	-	-	-	-	12	-	-